

PHILIPS



FA 9115

(GB) Amplifier	4
(F) Amplificateur	14
(D) Verstärker	24
(NL) Versterker	34
(E) Amplificador	44
(I) Amplificatore	54
(S) Förstärkare	64
(FIN) Vahvistin	74
(DK) Forstærker	84



PHILIPS

Guarantee and Service valid for Australia

The benefits given to the purchaser by this warranty are in addition to all other rights and remedies, which, under the Trade Practices Act or other Commonwealth or State law, the purchaser or owner has in respect of the product.

The Philips product carries the following warranties:

C-series HiFi-systems 12 months, Compact Disc Players: 12 months, Home Audio Systems: 6 months, Clock radios, portable radios, cassette recorders, cassette players and radio recorders: 90 days.

Any defect in materials or workmanship occurring within the specified period from the date of delivery, will be rectified free of charge by the retailer from whom this product was purchased.

Note: Please retain your purchase docket to assist prompt service.

Conditions of this warranty

1. All claims for warranty service must be made to the retailer from whom this product was purchased. All transport charges incurred in connection with warranty service or replacement will be paid by the purchaser.
2. These warranties do not cover batteries and extend only to defects in materials or workmanship occurring under normal use of the product where operated in accordance with our instructions.

**Philips Consumer Products Division,
Technology Park, Figtree Drive,
Australia Centre,
Homebush 2140, New South Wales**

Guarantee and Service valid for New Zealand

Thank-you for purchasing this quality Philips product.

Philips New Zealand Ltd guarantees this product against defective components and faulty workmanship for a period of 12 months. Any defect in materials or workmanship occurring within 12 months from the date of purchase subject to the following conditions will be rectified free of charge by the retailer from whom this product was purchased.

Conditions

1. The product must have been purchased in New Zealand. As proof of purchase, retain the original sales docket indicating the date of purchase.
2. The guarantee applies only to faults caused by defective components, or faulty workmanship on the part of the manufacturer.
3. The guarantee does not cover failures caused by misuse, neglect, normal wear and tear, accidental breakage, use on the incorrect voltage, use contrary to operating instructions, or unauthorised modification to the product or repair by an unauthorised technician.
4. Reasonable evidence (in the form of a sales docket) must be supplied to indicate that the product was purchased no more than 12 months prior to the date of your claim.
5. In the event of a failure, Philips shall be under no liability for any injury, or any loss or damage caused to property or products other than the product under guarantee.

This guarantee does not prejudice your rights under common law and statute, and is in addition to the normal responsibilities of the retailer and Philips.

How to claim

Should your Philips product fail within the guarantee period, please return it to the retailer from whom it was purchased. In most cases the retailer will be able to satisfactorily repair or replace the product.

However, should the retailer not be able to conclude the matter satisfactorily, or if you have other difficulties claiming under this guarantee, please contact

The Guarantee Controller, Philips New Zealand Ltd.

✉ P.O. Box 41.021 Auckland

☎ (09) 84 94 160

fax ☎ (09) 84 94 160

(MEX) México

NOM

Es necesario que lea cuidadosamente su instructivo de manejo.



NOM

(N) Norge

Typeskilt finnes bak på apparaten.

(GB) Englishpage 4

English

(F) Français.....page 14

Français

(D) DeutschSeite 24

Deutsch

(NL) Nederlandspagina 34

Nederlands

(E) Españolpágina 44

Español

(I) Italiano.....pagina 54

Italiano

(S) Svenska.....sida 64

Svenska

(FIN) Suomisivu 74

Suomi

(DK) Dansk.....side 84

Dansk

Thank you for selecting the Philips FA911 Integrated Stereo Control Amplifier.

An amplifier of the state-of-the-art Philips 900 series, the FA911 is engineered to fulfil the task of generating powerful sound with the highest achievable definition and minimum noise and distortion, supported by features such as:

- A full-function remote control which can handle your entire PHILIPS 900 series HiFi system as well as a TV set and a video recorder.
- Enhanced System Intelligence, offering increased ease of operation by extensive communication between the various components of your system.

Please read this manual carefully *before* you attempt to connect or operate the amplifier.

This manual is divided into five sections:

- **Installation:** explains how to set up your system.
- **Operation:** explains how to use your amplifier.
- **System Aspects:** explains the Enhanced System Intelligence feature and its benefits.
- **Remote Control:** gives detailed information on the operating functions of the system remote-control handset.
- **General Information:** includes maintenance information and technical data.

WARNING

Do not connect the set to the mains until all other connections have been made and the mains voltage (indicated on the type plate) has been checked.

When positioning the unit, bear in mind that every amplifier produces heat which must be able to dissipate freely. For this reason do not cover any vents and make sure that there is sufficient ventilation around the unit.

An open space of at least 5 cm at the sides, the back and the top of the stack is required.

FITTING A MAINS PLUG (U.K. only)

This apparatus is fitted with an approved moulded 13 Amp plug. To change a fuse in this type of plug proceed as follows:

- 1 Remove fuse cover and fuse.
- 2 Fix new fuse which should be a BS1362 5 AMP, A.S.T.A. or BSI approved type.
- 3 Refit the fuse cover.

If the fitted plug is not suitable for your socket outlets, it should be cut off and an appropriate plug fitted in its place.

If the mains plug contains a fuse, this should have a value of 5 A. If a plug without a fuse is used, the fuse at the distribution board should not be greater than 5 A.

Note: The severed plug must be disposed off to avoid a possible shock hazard should it be inserted into a 13 A socket elsewhere.

How to connect a plug

The wires in the mains lead are coloured in accordance with the following code: blue = neutral (N), brown = live (L).

As these colours may not correspond with the colour markings identifying the terminals in your plug, proceed as follows:

- 1 Connect the blue wire to the terminal marked N or coloured blue or black.
- 2 Connect the brown wire to the terminal marked L or coloured brown or red.
- 3 Do not connect either wire to the earth terminal in the plug, marked E or \pm or coloured green or green-and-yellow

Before replacing the plug cover, make certain that the cord grip is clamped over the sheath of the lead - not simply over the two wires.

If in doubt, consult a qualified electrician.

MAINS SUPPLY

- Check that the mains voltage as shown on the type plate corresponds to your local mains supply. If it does not, consult your dealer or service organisation.
- If your unit has a voltage selector, make sure **only** to change the voltage in the POWER OFF position.
- Insert the plug of the mains lead into the wall socket.
The mains supply is now connected.

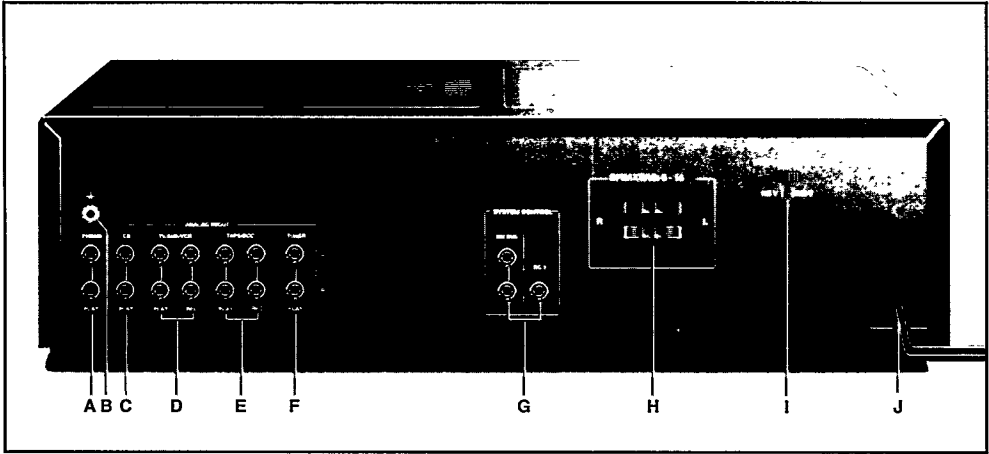

POSITIONING YOUR SYSTEM

The preferred order to stack the units of your system is shown in the diagram below.

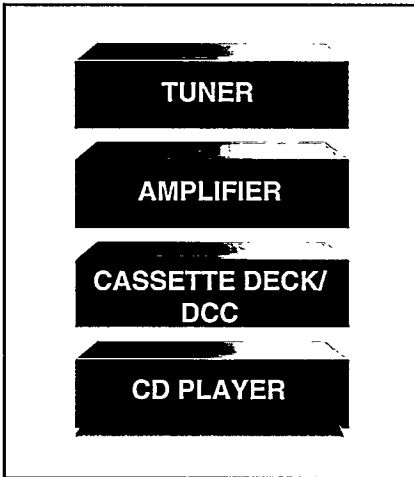

You only have to install your system once. Please make the following connections (whenever applicable).

Note: Switch off the amplifier before making any connections.

Important note for connecting equipment that does not have PLAY/REC markings on the input and output sockets:

CONNECTIONS:

FA 911 Device to be connected
 e.g. cassette deck

PLAY -> PLAY or OUT
REC -> REC or IN

- A PHONO**
Input (PLAY) sockets for connecting a record player.
- B PHONO GND** ‡
For connecting the earth wire of a record player.
- C CD**
Input (PLAY) sockets for connecting a CD player.
- D TV/AUX/VCR**
Input (PLAY) sockets for connecting the sound channel of a TV set or video recorder and output (REC) sockets for extra sound recording equipment e.g. a cassette or tape deck or a HiFi stereo video recorder.
- E TAPE/DCC**
Input (PLAY) and output (REC) sockets for connecting an analogue cassette deck or a Digital Compact Cassette recorder (DCC). In case you connect a DCC recorder, please use the remote control supplied with the recorder to operate the recorder.

The type plate is located on the back of the set.
This product complies with the radio interference requirements of the European Community.

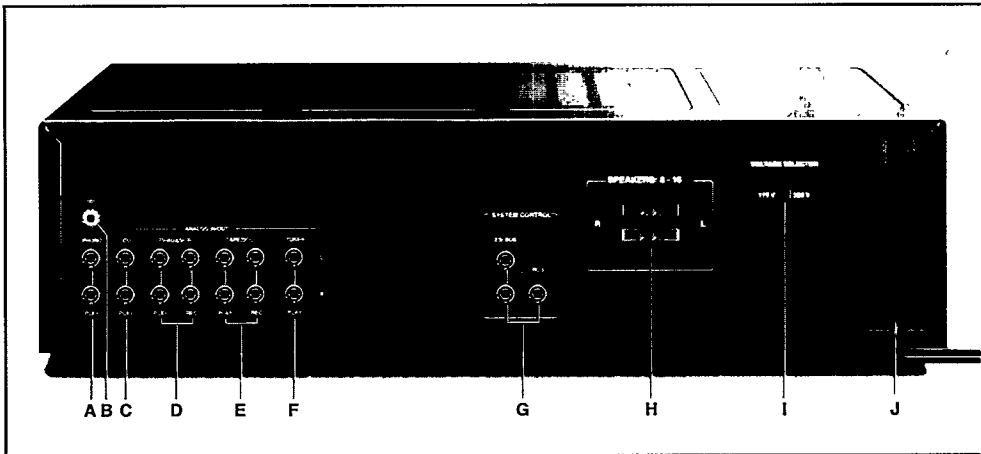

F TUNER

Input (PLAY) sockets for connecting a tuner.

G SYSTEM CONTROL

– **ESI BUS** (Enhanced System Intelligence) (coloured green) – remote-control input/output sockets for connection to the corresponding ESI sockets of other components in your HiFi system (e.g. the Philips 900 series)

Connect the ESI socket to the ESI socket of the external equipment that uses the ESI remote control system. In this way you can operate external sets by remote control through the sensor of the amplifier.

– **RC-5 BUS** (coloured orange) – remote-control input/output socket for connection to the corresponding RC-5 socket of e.g. a CD player or remote control receiver EM 2200/2201. Connect the RC-5 socket to the RC-5 socket of the external equipment that uses the RC-5 remote control system.

This socket has been added to maintain compatibility with older Philips Audio equipment.

H SPEAKERS

terminals for connecting a pair of speakers, impedance 8-16 ohms (L = left, R = right)

- One of the wires of a loudspeaker cable is marked, e.g. with a colour or rib. Connect the marked wire to the red terminal, the non-marked wire to the black one. Make sure that both loudspeakers are connected in the same way.

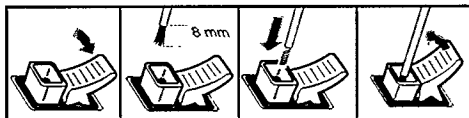

I Voltage selector 110/127 V - 220/240 V – for selecting the mains voltage (not on all versions)

J Mains lead

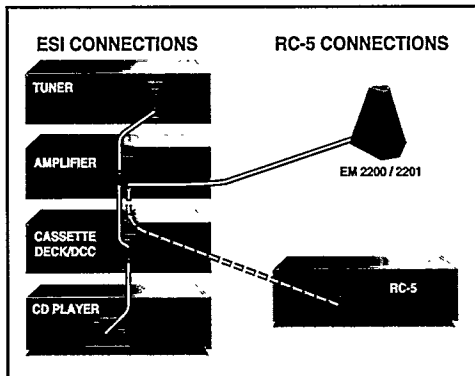

After having made all the necessary connections (some may not be applicable for your set-up), your system is ready for use.

In the next chapter we will describe how to operate it.

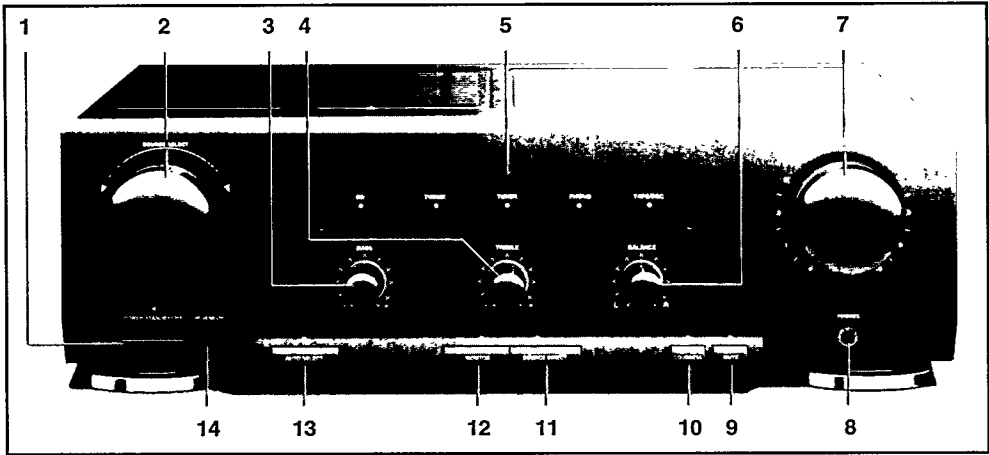

POWER STANDBY/OFF

- 1 **POWER STANDBY/OFF** – for switching on in standby mode
- 2 **SOURCE SELECT** – for selecting the desired listening source
- 3 **BASS** – for adjusting the bass tones
- 4 **TREBLE** – for adjusting the high tones
- 5 **Indicators** – showing:



- the selected source: **CD, TV/AUX, TUNER, PHONO, TAPE/DCC.**
- 6 **BALANCE** – for adjusting the balance of the volume between the left and right speakers
- 7 **VOLUME** – for adjusting the volume level
- 8 **PHONES** – socket for stereo headphones
 - You may connect a pair of stereo headphones with 6.3 mm plug to this socket. Inserting the plug will disconnect the speakers.
- 9 **MUTE** – for decreasing the volume by 20 dB (= factor 10)
- 10 **LOUDNESS** – for increasing the treble and bass response at low volume settings to match human perception
- 11 **SOURCE DIRECT** – for bypassing the tone control in order to obtain the shortest possible signal path
- 12 **MONITOR** – for selecting the audio signal of the source you are recording to (TAPE/DCC)
- 13 **AUTO SELECT** – for switching on and off the Enhanced System Intelligence (ESI) system (See System Aspects)
- 14 **IR SENSOR** – infrared remote control eye

- Press the **POWER STANDBY/OFF** key 1 to switch on the power. The amplifier will enter the standby mode and the indicator above this key will light up. When **AUTO SELECT** is activated, the indicator of this key also lights up during standby. When the amplifier is switched to active mode (as described below in the chapters 'Wake-up from standby' and 'SOURCE SELECTION'), the respective indicators light up and the standby indicator is switched off. When a remote control command is received, this standby indicator flashes.
- To switch off the amplifier or system press the **POWER STANDBY/OFF** key again.

STANDBY

- Switching a set or your whole system to standby can only be done via the remote control.
- To switch a single source (e.g. TUNER) to standby:
 - Select the source using the source keys on the remote control.
 - The selected source will be switched to standby if the standby key is pressed briefly.
- If the standby key is kept pressed for more than approx. 1 second the whole system will be switched to standby. All light indicators will be switched off with the exception of the standby indicator on the amplifier. When AUTO SELECT is activated, the indicator of this key also lights up during standby.
- NOTE:** If the whole system is switched to standby when a recording is active, the recording (or CD-dubbing) will be cancelled.

Wake-up from standby

There are several options to switch your system from standby back to operating mode:

- turning the rotary SOURCE SELECT knob 2;
- selecting a source with your remote control.
- When AUTOSELECT is activated, several keys on equipment connected via the ESI BUS sockets that activate a play function may also be used as wake-up keys (e.g. PLAY, SCAN, PRESET).

SOUND CONTROL

- Adjust the sound level with **VOLUME 7**.
- Adjust the stereo balance between the left and the right channels with **BALANCE 6**.
- Adjust the bass tones with **BASS 3** and the high tones with **TREBLE 4**.
WARNING: Extreme settings at high volume result in a high distortion level and may damage your loudspeakers!
- Press **LOUDNESS 10** if you want to increase the bass & treble response at low volume settings.
- Press **MUTE 9** if you want to decrease the volume by 20 dB.
- Press **SOURCE DIRECT 11** if you want to bypass the tone control. Bass and treble will now be deactivated.

SOURCE SELECTION



- When the amplifier is in standby mode, it will be switched directly to operating mode as soon as the SOURCE SELECT knob is turned.
- The amplifier and the selected source (indicated on the display) will become active.
NOTE: A selection is only made when the turning is stopped for more than one second (to prevent all sources becoming active while the knob is turning).
- By turning the SOURCE SELECT knob one step to the left, you select the source to the left of the current source.
- By turning the SOURCE SELECT knob one step to the right, you select the source to the right of the current source.
- When AUTO SELECT is activated, you can switch both the source and the amplifier to active mode by simply pressing 'PLAY' on CD or Deck or one of the tuner preset keys.

Source selection via the remote-control handset

- Press (**for more than 1 second**) the respective source key on the remote control. The selected source and the amplifier will become active.

MONITOR

During recording, you can select the audio signal of the source you are recording to (e.g. TAPE) by pressing the MONITOR key 12. The indicator above this key will light up and you will now hear the sound as how it is being recorded. When the MONITOR function is switched off (the indicator does not light up) you will hear the sound of the source you are recording from (e.g. TUNER, CD).
Note: When you have selected TAPE with the source select knob or when you have activated CD-synchro, the MONITOR function can not be activated.

ENHANCED SYSTEM INTELLIGENCE

If you have connected equipment to your amplifier via the ESI sockets and when AUTO SELECT 13 is activated, there will be an additional internal communication between the different elements in your system.

The whole system can be operated by the system remote control through the sensor of the amplifier.

In addition, the functions AUTOMATIC SOURCE SELECTION and AUTOMATIC STOP as mentioned below are then accessible:

IMPORTANT:

Some products of the Philips 900 series which are equipped with their own remote control, also have an IR SENSOR ON/OFF switch on the back of the unit.

When these units are incorporated in your HiFi system with an ESI BUS connection, this IR SENSOR ON/OFF switch should always be in the OFF position.

The unit can then be operated with the remote control of your FA911 amplifier.

Make sure that the respective unit is **switched off** when switching the IR SENSOR on and off.

AUTOMATIC SOURCE SELECTION

Equipment connected via the ESI sockets to the amplifier is automatically selected as the source by pressing any button that activates the play function e.g. PLAY, SCAN, PRESET.

Example: If you press the PLAY key on your CD while listening to your tuner, the source CD will be selected.

AUTOMATIC STOP

When the selected source is in the play mode, it will always be stopped automatically as soon as another source is selected.

Example: If you select TUNER with the SOURCE SELECT knob while listening to your CD, the CD player will be stopped (PAUSE).

TIMER

When making use of the timer function of your Philips 900 series tuner (e.g. FT930) the amplifier has to be in standby mode.

A timer request will be disregarded if the amplifier is activated.

The timer function can be used as e.g. an alarm clock or to make an unattended recording at a specific time.

Further information can be found in the instructions for use of your tuner.

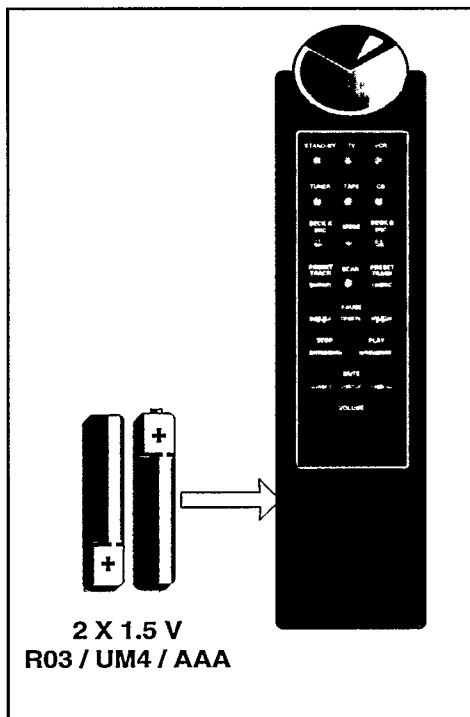

The remote control supplied can be used to operate all units in the system which are connected via the ESI sockets. In addition, it can be used to operate any other equipment that uses the RC-5 remote control system.

IMPORTANT:

Some products of the Philips 900 series which are equipped with their own remote control, also have an IR SENSOR ON/OFF switch on the back of the unit.

When these units are incorporated in your HiFi system with an ESI BUS connection, this IR SENSOR ON/OFF switch should always be in the **OFF** position.

The product can then be operated with the remote control of your FA911 amplifier.

When these units are not used in a HiFi system the switch should be in the **ON** position.

Make sure that the respective unit is **switched off** when switching the IR SENSOR on and off.

Remote control from another room

You can control the system from another room by placing a EM 2200/2201 'Pyramid' remote-control receiver in the room and connecting it to the RC-5 input on the amplifier. The 'Pyramid' will pass on signals from the remote-control handset to the amplifier.

BATTERIES

- Open the battery compartment and insert two batteries as indicated, type R03, UM-4 or AAA-cells .
- Remove the batteries when they have run down or if they will not be used again for a long period.

USING THE REMOTE CONTROL

- First select the source you wish to control by pressing one of the source select keys on the remote control (e.g. TAPE, CD).
- Then, select the desired function.

AMPLIFIER

- **VOLUME** - for adjusting the volume
- **Source selectors**
- **MUTE** - for decreasing the volume by 20 dB
- **STANDBY** - for switching the complete system to standby by pressing for longer than approx. 1 second

TUNER

- **PRESET/TRACK** - next + or previous – preset station
- **◀** - to search down
- **SCAN** - for scanning preset stations
- **MODE** - for mono/stereo selection
- **▶** - to search up
- **STANDBY** - for selecting standby mode

CASSETTE DECK

- **PRESET/TRACK** - next + or previous – track
- **PLAY** - for starting play
- **STOP** - for stopping recording/play
- **PAUSE** - for interrupting recording/play
- **▶** - for winding the tape in the playing direction
- **◀** - for winding the tape in the opposite direction
- **DECK A/DECK B** - for selecting deck A or B
- **MODE** - for selecting the tape travel direction
- **STANDBY** - for selecting standby mode

CD

- **PRESET/TRACK** - next + or previous - track
- **◀** - to search down
- **▶** - to search up
- **SCAN** - for automatically playing the beginning of each track
- **PLAY** - for starting play
- **STOP** - for stopping play
- **PAUSE** - for interrupting play
- **MODE** - for playing in random order (SHUFFLE)
- **DISC +** - (CD changer only) - for disc selection
- **STANDBY** - for selecting standby mode

TV

- **VOLUME** - for adjusting the volume
- **PRESET** - for next + or previous - preset station
- **MODE** - for language selection
- **STANDBY** - for selecting standby mode

VCR

- **PRESET** - next \approx or previous \approx station
- **SCAN** - for scanning a tape
- **PLAY** - for starting playback
- **STOP** - for stopping recording/play
- **PAUSE** - for interrupting recording/play
- **▶▶** - for winding the tape
- **◀◀** - for rewinding the tape
- **MODE** - for language selection
- **STANDBY** - for selecting standby mode

MAINTENANCE

- Do not leave the unit for any length of time in direct sunlight or other places where high temperatures can occur, such as in the vicinity of heating apparatus.
- Do not expose the equipment to humidity or rain.
- A chamois leather slightly moistened with water is sufficient for cleaning the cabinet
- Do not use cleaning agents containing alcohol, spirits, ammonia or abrasives.

TECHNICAL SPECIFICATIONS

(Subject to modification)

- Output power:
 -DIN 1 kHz ($D \leq 0.7\%$) 2x40 W (8 Ω)
 -IEC 581.6 ($D \leq 0.7\%$) 2x35 W (8 Ω)
- Music Power (1 kHz, 8 Ω)2x78 W
- Total harmonic distortion: $\leq 0.01\%$ at 30 W/1 kHz
- Intermodulation distortion: $\leq 0.01\%$ at 30 W
- Power bandwidth:10 - 60,000 Hz (at -3dB)
- Frequency response:
 - linear inputs15 - 40,000 Hz, ± 1 dB
 - phono input20 - 20,000 Hz, ± 1 dB
- Signal-to-Noise Ratio:
 - linear ≥ 98 dBA typical
 - phono ≥ 77 dBA typical
- Stereo separation at 1 kHz: ≥ 75 dB
- Crosstalk at 1 kHz: ≥ 90 dB
- Damping factor ≥ 50 at 8 Ω
- Bass/Treble control... ± 10 dB at 100 Hz/10 kHz
- Loudness.....+ 6/+ 4 dB at 100 Hz/10 kHz

INPUT SENSITIVITY

Phono MM:2.5 mV at 47 k Ω (rated output)
 Linear inputs: ...150 mV at 22 k Ω (rated output)

OUTPUTS

VCR:150 mV at 2.5 k Ω
 TAPE:150 mV at 2.5 k Ω
 Headphones:8 - 1,000 Ω
 Loudspeakers:8 - 16 Ω

REMOTE CONTROL SYSTEM

.....Enhanced System Intelligence Bus
+ RC-5 Bus

POWER SUPPLY

Mains voltages:acc. to type plate
 Power consumption:20 - 150 W

CABINET

Dimensions (w x h x d):...435x140x300 mm approx.
 Weight:6.1 kg approx.

ACCESSORIES

.....1 x Remote control,
 3 x Remote control cable
 2 x batteries for remote control

SYMPTOM	POSSIBLE CAUSE	REMEDY
<ul style="list-style-type: none"> - No sound from loudspeaker. 	<ul style="list-style-type: none"> - Volume is turned down low. - 'MUTE' is active. - Loudspeakers are not connected. - Loudspeaker cables are connected with the plastic isolation still on them. 	<ul style="list-style-type: none"> • Turn up the volume. • Press MUTE again to deactivate. • Connect loudspeakers correctly. • Strip off the plastic isolation (8 mm) before connecting the cables.
<ul style="list-style-type: none"> - Sound from only one loudspeaker. 	<ul style="list-style-type: none"> - One of the loudspeaker cables is not connected or damaged. - Balance is not in middle position. 	<ul style="list-style-type: none"> • Connect the cable or replace with one of good quality - Turn balance to middle position.
<ul style="list-style-type: none"> - Remote control is not possible. 	<ul style="list-style-type: none"> - The batteries have run down. 	<ul style="list-style-type: none"> • Insert new batteries.
<ul style="list-style-type: none"> - In a system set-up the relevant source is not selected automatically when a function of that source is chosen. 	<ul style="list-style-type: none"> - The AUTO SELECT function of the amplifier is not activated. - The IR-SENSOR of the CD (DCC) player/changer has not been switched off. 	<ul style="list-style-type: none"> • Press the AUTO SELECT button. • First switch off the CD (DCC) player/changer. Then switch off the IR-SENSOR of the CD player/changer (DCC).
<ul style="list-style-type: none"> - Hum audible when phono is selected. 	<ul style="list-style-type: none"> - No proper grounding of turntable. 	<ul style="list-style-type: none"> • Connect turntable ground to phono ground screw.
<ul style="list-style-type: none"> - In STAND BY mode the apparatus becomes slightly hot. 	<ul style="list-style-type: none"> - This is normal. Every amplifier generates heat. 	<ul style="list-style-type: none"> • No action.

SYMPTOM	POSSIBLE CAUSE	REMEDY
<ul style="list-style-type: none"> - The other components in the 900 system do not react to remote control commands. 	<ul style="list-style-type: none"> - ESI BUS cables are not connected properly. - AUTO SELECT is not active. - The RC-5 and ESI BUS connections are mixed up. - The IR-SENSOR switch at the back of the connected set is in the ON position. 	<ul style="list-style-type: none"> • Connect ESI BUS cables according to description in these instructions for use. • Press the AUTO SELECT button. • The RC-5 BUS should only be connected to a RC-5 socket and the ESI BUS should only be connected to an ESI socket. • Set the IR SENSOR switch to OFF.
<ul style="list-style-type: none"> - Tone control (bass/treble) has no effect. 	<ul style="list-style-type: none"> - SOURCE DIRECT is active. 	<ul style="list-style-type: none"> • Press the SOURCE DIRECT button.
<ul style="list-style-type: none"> - Remote control commands are not properly received. 	<ul style="list-style-type: none"> - The distance between remote control and apparatus is larger than 10 metres. 	<ul style="list-style-type: none"> • Use remote control receiver EM2200/2201. • Reduce the distance between remote control and apparatus.
Empty cell	Empty cell	Empty cell



FA 911

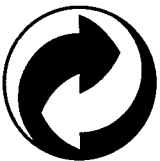

3104 215 3544 2

Printed in Singapore

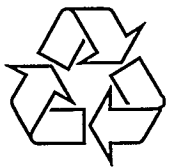

TC text/RR0893/1